



Cryogenic Stainless Steel Globe Valve

DN65 - DN100

Description

Stainless Steel extended stem globe valve with bolted bonnet, integral seat and renewable PTFE disc, complete with bronze internals. Supplied as standard with butt weld ends, the valve is of the cone seat design for drop tight shut off. The bolted bonnet allows easy maintenance, even in confined spaces with lower bolting torques required than for an equivalent size union bonnet valve. All valves are degreased for oxygen duty, assembled in clean room conditions and pressure tested prior to despatch. Valves with full stainless steel internal components available on request.

Maximum Working Pressure (MWP)

(Subject to End Connections)

Extended stem - 50 Bar (725 psi) at -196°C to +65°C

Features

- Unique Bestobell loose flange bolted bonnet design allows for thermal expansion and contraction and eliminates leakage at the bonnet gasket
- Precision investment cast body – smooth surface finish
- PTFE seat to ensure tight shut off at all times
- Lightweight therefore excellent thermal characteristics and increased payload on mobile tanker application
- Designed and engineered specifically for cryogenic service
- Anti-blow out spindle and one-piece high strength for operator safety
- Long life, low torque spindle thread
- Screwed and welded high strength extension tube / bonnet joints
- Revolving disc ensures non-rotating seat contact for extended leak-free seat life
- Full bore
- Fast/easy maintenance of PTFE components



Technical

Manual operated, inside screw, Globe valves size ranges DN65, DN80 and DN100.

Designed and engineered for use with O₂, N₂, Ar, CO₂, He, Kr, Ne, H₂, C₂H₄ and N₂O service. Actuated valves available on request.

ISO 9001 accreditation – designed and manufactured to ASTM B31.3 and BSEN 1626.

Optional full material traceability backed by BSEN 10204 3.1/3.2 certification.

Supplied as standard with butt weld schedule 10 ends, but also available with socket ends.

CE Marking according to Pressure Equipment Directive 97/23/EC.

π Marking to Directive 99/36/EC

For other options please contact us.



Cryogenic Stainless Steel Globe Valve

DN65 - DN100

Materials

Body	ASTM A351 CF8M
Bonnet	ASTM A276 316
Tube, Extension	ASTM A312 TP 304L
Stem	ASTM A276 316
Handwheel	Aluminum / Iron
Disc	BSEN 12164 CW 721R
Bonnet Insert	BSEN 12163 CW 451K
Seal	PTFE
Gasket Bonnet	SIGMA 511
Bonnet Flange	Stainless Steel Series 300
Gland Packing	PTFE
Fasteners	BS6105 A4 Gr.70

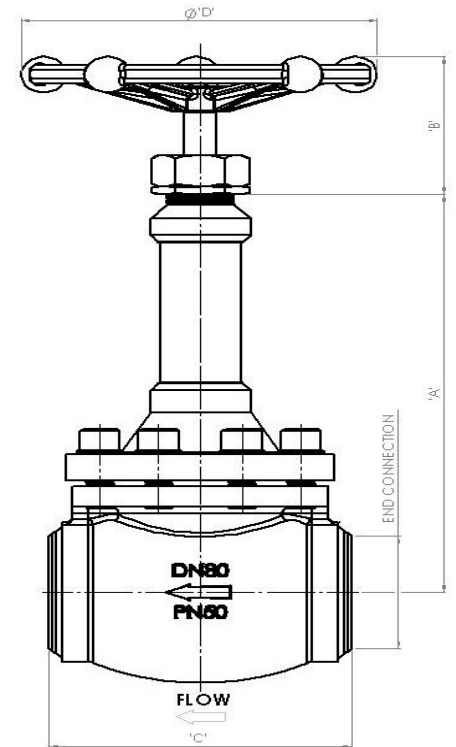

Specifications

Dimension	Unit	DN65	DN80	DN100
Part No		CNT90B1D4C	CNTA0B1D4C	CNTB0B1D7C
A	mm	300	300	400
B	mm	120	104	160
C	mm	178	180	250
D	mm	150	212	406
CV	US gpm	68	98	174
Weight	Kg	11.6	14.8	25

All dimensions / weights are approximate